

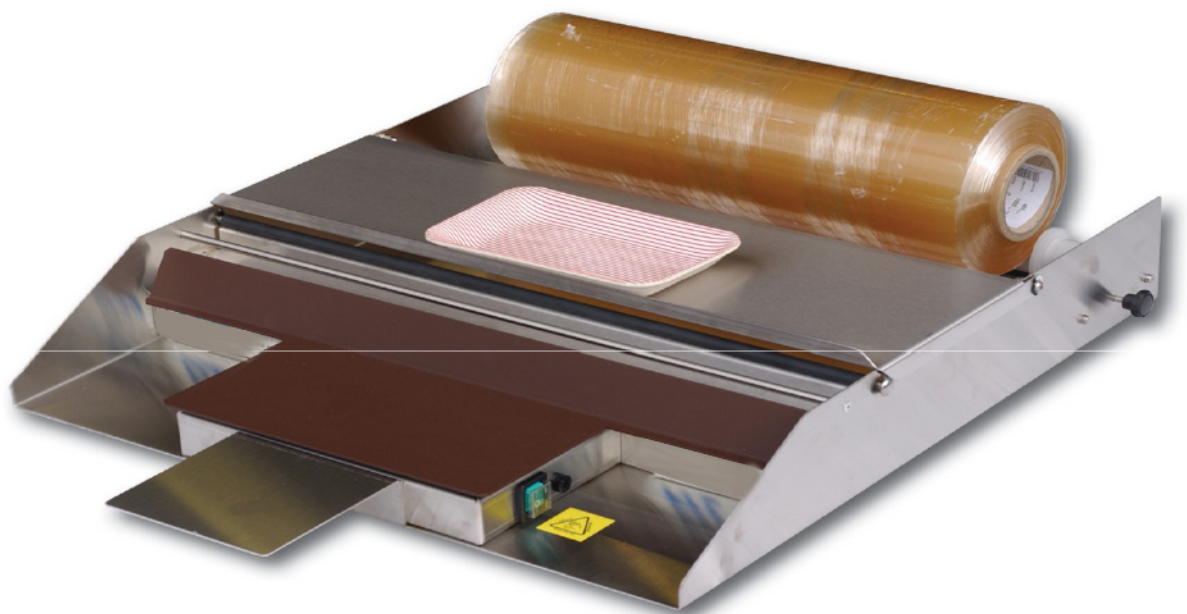

INSTRUCTION MANUAL

PFE 1 / 11

SHRINK-WRAP FILM DISPENSER



Instruction Manual			
	Shrink-wrap film dispenser : PFE 1 / 11		
	Emis par :	Bureau d'Etudes	Page :

CAUTION:

For any difficulties of starting, functioning or maintenance:
 → Please contact our service after sale **33 (0)4 72 23 23 98**

This note will allow you the use and the maintenance of your Paper sealer. The indications must be scrupulously respected.

The characteristics and indications given in this instruction manual can be subjected to modifications without advance notice.

Although all the precautions are taken to insure the exactness of the information given in this document, CCM cannot be considered as person in charge of the errors or the omissions being in the illustrations or the texts.



Marks mentioned in the text make references to pages for spare parts.

SOMMARY :

<i>SPECIFICATIONS</i>	2
<i>GENERAL FEATURES</i>	3
<i>CONNECTION</i>	3
<i>OPERATING PROCEDURE</i>	3-4
<i>MAINTENANCE</i>	4
<i>INCIDENTS OF FUNCTIONING</i>	5
<i>WIRING DIAGRAM OF ELECTRIC COMPONENTS</i>	5
<i>SPARES PARTS</i>	6
<i>SPARE LISTING</i>	6

1 - SPECIFICATIONS

- Type of machine : Shrink-wrap film dispensers
- **PFE 1** : painted version, **PFE 11** : inox version
- Dimensions : 650x650x160 mm,
- Maximum capacity of film : 600 mm,
- Maximum dimensions of container 250x200 mm
- Supply voltage: 230 V single phase and earth - 50/60 Hz,
- Power unit : 360 W,
- Temperature heating element: > 100° C,
- Silent in operation

Instruction Manual						
 	Shrink-wrap film dispenser : PFE 1 / 11					
	Emis par :	Bureau d'Etudes			Page :	3 / 6

2 – GENERAL FEATURES

CAUTION :

The goods travel at the risks and the dangers of the customer, it is up to him to verify the state and to emit, if necessary reserves with the carrier.

- Unpack your shrink-wrap Oter les différents adhésifs et plastiques de protection,
- Remove various adhesives and plastics of protection.
- Put the shrink-wrap film dispenser on a horizontal work plan.

3 - CONNECTION

CAUTION :

All the heat element is for a temperature superior to 100 ° C. Any prolonged manual contact can provoke burns.

- The tension of supply is 230 single-phase V.
- The installed power is 360 W,
- Connect the plug in a standard grip 16 Has. + earth,
- Activate the green switch " I/O " (by resting on "I"). The light will illuminate.
- Wait 15 minutes to get the machine ready before making the tries.
- The electric circuit is protected by a fuse.

4 – OPERATING PROCEDURE

- When the plate is warm, seize the film of each extremity with both hands between the roller presseur (rep. 31) and the blade of preservation (these pieces are always cold and the axis of preservation serves as support for hands),
- Pull the necessary film towards you the upholder slightly tightened above the heating fish edge (see sketch: p. 4). The fact to put in contact the film about the warm fish edge is enough to cut it.
- Position a pastry boat on the removable tray in abutment on the edge before
- Pull the quantity of necessary film towards you by maintaining the slightly tightened film, to pull it down under the pastry boat
- Take the pastry boat on sides with the film and bring the whole on the heating plate (put and remove immedialtely the pastry boat). This movement allows to wrap the pastry boat and to cut the film,

Seize quickly the pastry boat and position it on the plate rolling film (rep.: 24), then to pull on each side the surplus of film and pull it down under the pastry boat,

- Put back the product on the heating plate a short moment to stick everything together.
- You can adjust the tension of the film by means of the knob brake situated to the right of the rollers reels.

5 – MAINTENANCE

CAUTION :

The heating element should never be cleaned with a cutting object, otherwise you will damage it. You should use a wet rag.

- Pay attention not to pour any liquid on the heating resistance, the switch, the fuse during the cleaning.

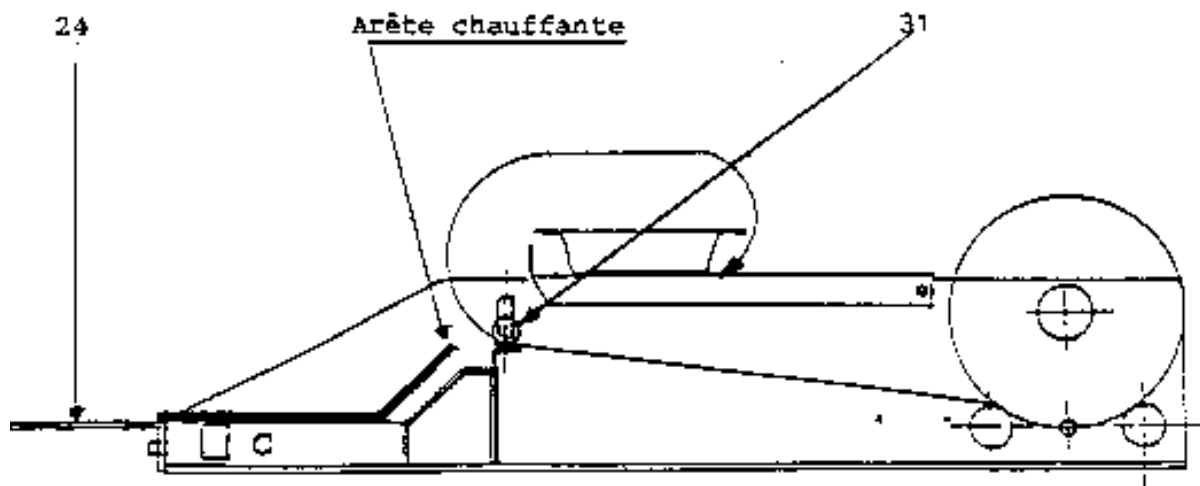

6 - INCIDENTS OF FUNCTIONNING

The machine does not work any more:

- Verify that the switch "ON / OFF" is switched on.
- Verify the fuse

The heat element doesn't work:

- Verify the resistance's supply

The cup(cutting) hurts:

- Tighten the knurl saw (rep.23) of the plate brake rollers, and tighten the film hanging the cutting.

7 – WIRING DIAGRAM OF ELECTRIC COMPONENTS

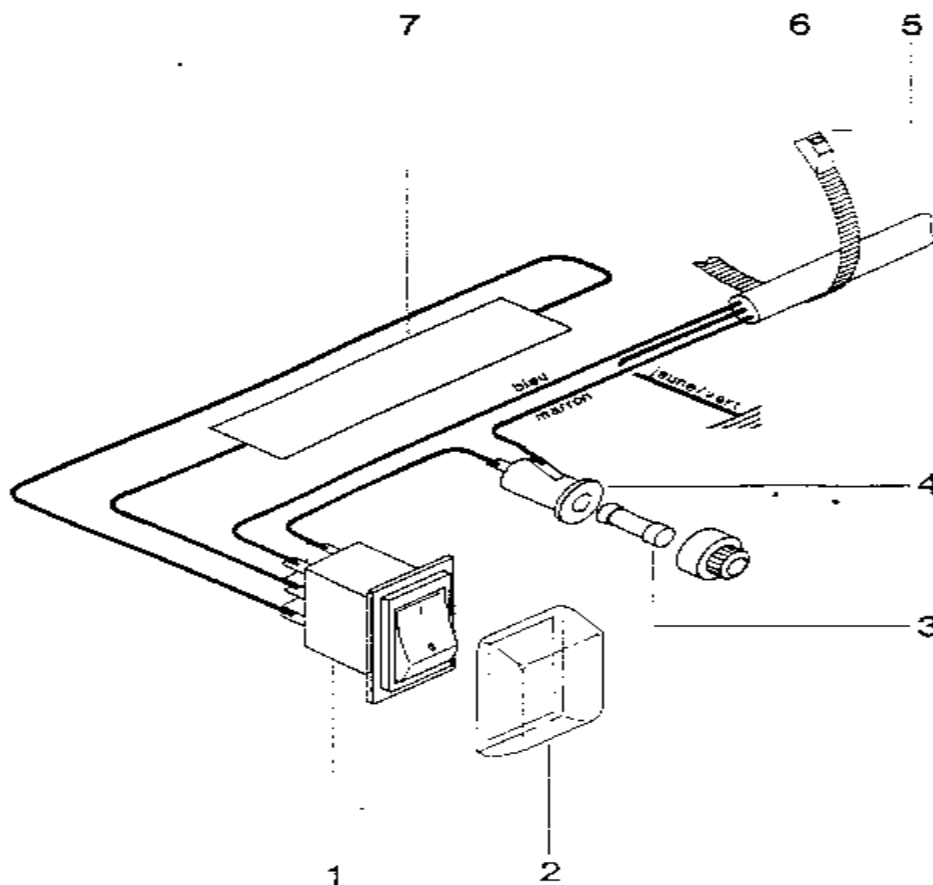

8 – SPARE PARTS

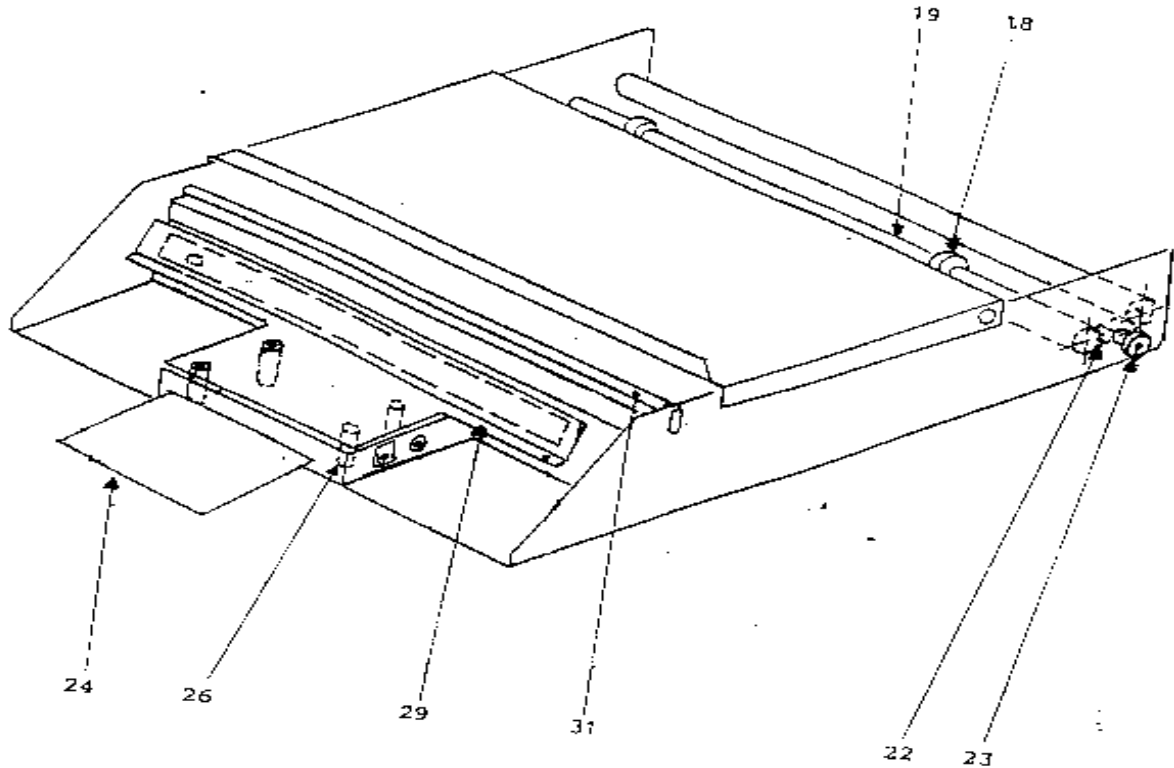

9.- SPARES LISTING

REPERES	REFERENCES	DESIGNATIONS	QUANT.
1	20302001	Switch	1
3	20310001	Fuse 5x20 2A	1
4	20303001	Fuse support 5x20	1
5	20301002	Grey cable 3x0.75_ 2M	1
7	20409001	Heating element 360W _460x40x4	1
18	2084	Jubile clip D 40	2
19	20528002	PVC Roller 40 x 620	2
22	3261	Plate brake roller 40	1
23	20502001	Screw 6x17	1
24	79	Film dispenser	1
26	20507001	Entretoise acier N M4 x 50	4
29	66	Heating plate 600	1
31	3259	Film shaft	1